

MIMIC 22.5 Cutout square body **Legend** lamp

MIMIC

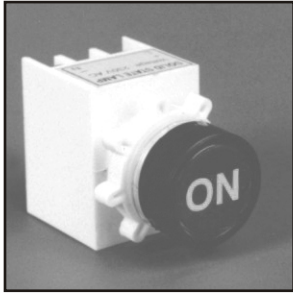

○ Ø 22.5mm Cutout

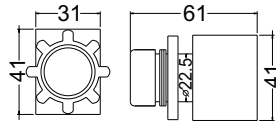

Available voltage:
 6,12,24,48,110,240,415 VAC
 6,12,24,48,110,220 VDC
 6,12,24,48,110,220 VAC/DC

Rugged design
 Proven performance
 0.5 Watt

Also available Green steady Red Flasher or vice versa or any combination with any two colour.
 Adjustable time 0 to 180 sec.

Indicates actual legend like R, Y, B, ON, OFF, TRIP, PUMP ON etc.

Code

L/LEG 22	Red, Green, Amber
L/LEG 22	White, Blue
BIL/LEG 22	Bicolour lamp Red, Green, Amber
TRL/LEG 22	Tricolour lamp Red, Green, Amber
FL/LEG 22	Flasher lamp Red, Green, Amber
RL/LEG 22	Relay lamp with single change over contact
RL/LEG 22	Relay lamp with double change over contact
← S+FL/LEG 22	Steady + Flasher lamp Red, Green, Amber
TL/LEG 22	Timer lamp with single change over contact
← TL/LEG 22	Timer lamp with double change over contact
OCL/LEG 22	Open collector lamp with single output transistor
OCL/LEG 22	Open collector lamp with double output transistor

TRUTH TABLE FOR "AND LAMP"

INPUT - 1	INPUT - 2	INDICATION	RELAY
✓	✗	✗	Denergised
✗	✓	✗	Denergised
✓	✓	✓	Energised

← LOL/LEG 22	Logic 'AND' lamp with single change over contact
LOL/LEG 22	Logic 'AND' lamp with double change over contact

TRUTH TABLE FOR "OR LAMP"

INPUT - 1	INPUT - 2	INDICATION	RELAY
✓	✗	✓	Energised
✗	✓	✓	Energised
✓	✓	✓	Energised

← LOL/LEG 22	Logic 'OR' lamp with single change over contact
LOL/LEG 22	Logic 'OR' lamp with double change over contact

For 110 VDC, 220 VDC

For 415 VAC

Lamp with fire retardant body